



# Sparta Area School District Community Education Program



## Mind Over Miles Registration Form

### Personal Information

Name: \_\_\_\_\_ Phone: \_\_\_\_\_

Address: \_\_\_\_\_  
Street City Zip

Email: \_\_\_\_\_

By signing below, and in consideration for being allowed to participate in Mind Over Miles, I agree to assume all risks and responsibilities related to participating in Mind Over Miles and walking inside District buildings, along with following the program expectations. I agree to indemnify and hold the Sparta Area School District, the Board of Education, and its employees, officers, coaches, volunteers, agents and representatives harmless from any and all claims and damages resulting from or relating to any accident or injury arising from my participation in Mind Over Miles, walking inside District buildings.

Signature: \_\_\_\_\_ Date: \_\_\_\_\_

----- OFFICE USE ONLY -----

Background Check \_\_\_\_\_

Walker Badge # \_\_\_\_\_ Checked-Out \_\_\_\_\_ Returned \_\_\_\_\_



## Sparta Area School District Community Education Program



### Mind Over Miles

**What:** The purpose of Mind Over Miles is to provide an indoor site for community members to exercise, while also keeping everyone safe while student-athletes may be in the hallways for practice.

**Where:** Sparta High School, entering and exiting through door E

**When:** Monday - Friday between 4:00p and 9:00p November 1st - May 1st

**How:** Bring the following to the High School office at 506 N. Black River St between the hours of 8:30-3:00

- Drivers license for a background check
- The attached registration form
- Return your badge to the office by May 15th

#### Things to know (expectations):

1. Always enter **and** exit through door E
2. Stay in the 100 & 200 hallways
  - a. If you have an engagement in another part of the building, you must exit through door E then re-enter the building at the location of your next commitment
3. Entering classrooms is not permitted
4. Wear your walkers ID badge whenever in the building
  - a. For the safety of all, sharing your badge is not allowed
    - i. Each walker must have his/her own badge
5. Replacement badges cost \$10
6. Be responsible for your own safety within the building
7. Be aware of your surroundings
8. Walking is not allowed when the building is closed due to weather conditions, emergencies, holidays etc.

#### Questions?

Please contact Holly Church, Community Education Coordinator at [hchurch@spartan.org](mailto:hchurch@spartan.org) or 608-633-1807

# SPARTA HIGH SCHOOL

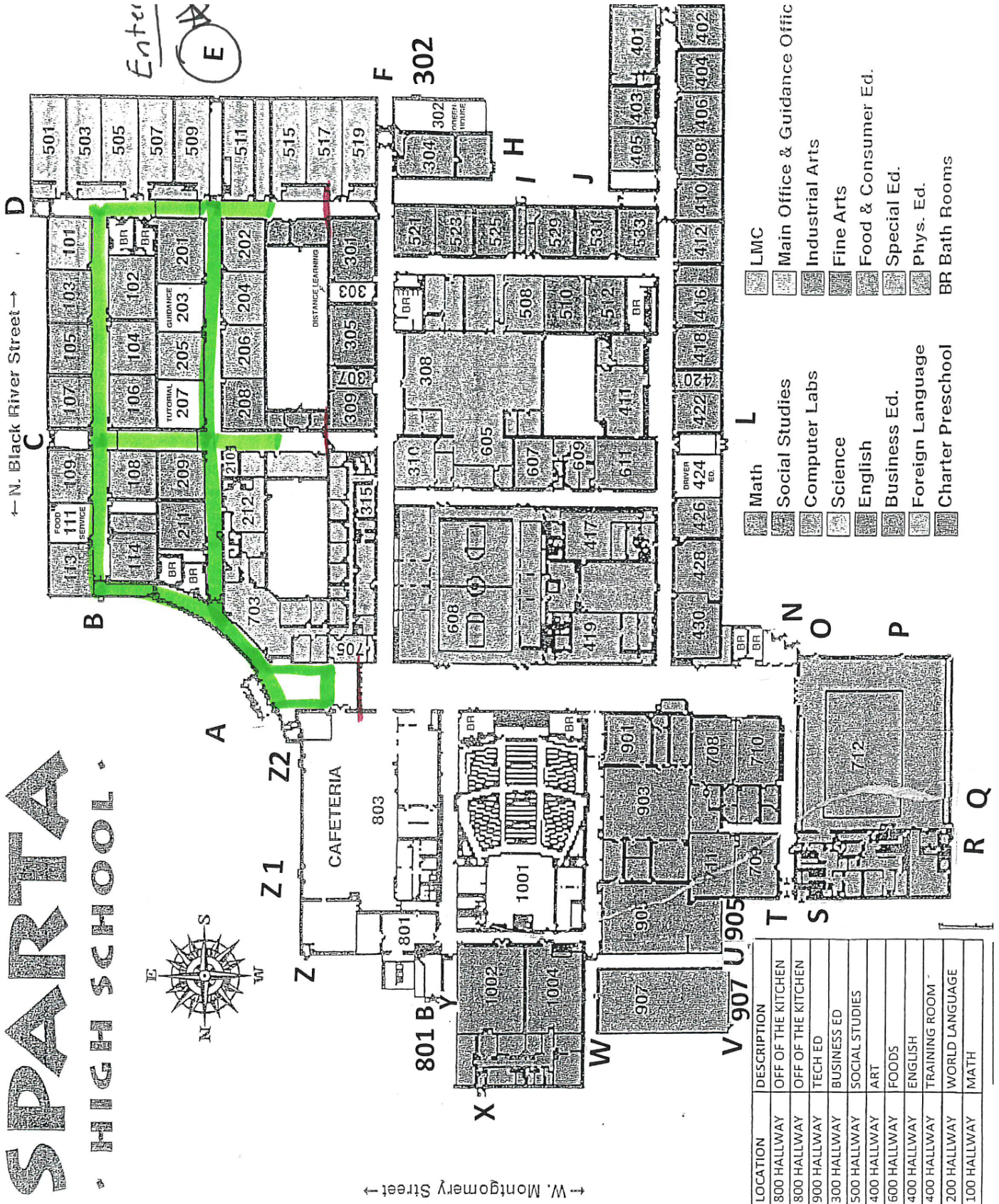
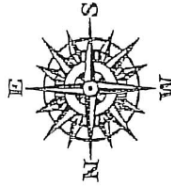

- LMC
- Main Office & Guidance Office
- Industrial Arts
- Fine Arts
- Food & Consumer Ed.
- Special Ed.
- Phys. Ed.
- BR Bath Rooms
- Math
- Social Studies
- Computer Labs
- Science
- English
- Business Ed.
- Foreign Language
- Charter Preschool

DOCK	LOCATION	DESCRIPTION
001-0024	800 HALLWAY	OFF OF THE KITCHEN
065-0076	900 HALLWAY	OFF OF THE KITCHEN
101-0220	900 HALLWAY	TECH ED
220-0300	300 HALLWAY	BUSINESS ED
301-0420	500 HALLWAY	SOCIAL STUDIES
421-0520, 0531-0600	400 HALLWAY	ART
601-0710, 0721-0780	600 HALLWAY	FOODS
781-0951	400 HALLWAY	ENGLISH
952-1029	400 HALLWAY	TRAINING ROOM
1195-1353	200 HALLWAY	WORLD LANGUAGE
354-1499	100 HALLWAY	MATH